

## Instrukcja Użytkownika

Beta Wózek inwalidzki  
specjalny dziecięcy

Nr katalogowy: 15770000



# WIMED

TECNOLOGIE MEDICALI

Bw rpw sr p k n  
sj U Rwkglgcaigce 00 0  
7 1 7  
rrn k nj

Uwr pa K tg n  
Tg Bg lcA g Kgj l

k tgep sn a k  
gkc gld k tgep sn a

## INSTRUKCJA UŻYTKOWNIKA

Beta Wózek inwalidzki specjalny  
dziecięcy

Nr katalogowy: 15770000



**INDEX:**

<b>1. GENERAL INFORMATION:</b> p.3
<b>2. SAFETY WARNINGS:</b> p.4
<b>3. PRODUCT DESCRIPTION:</b> p.6
<b>4. TECHNICAL FEATURES:</b> p.7
<b>5. DRIVING TECHNIQUES:</b> p.8
<b>6. ASSEMBLY AND ADJUSTMENTS:</b> p.9
<b>7. ACCESSORIES:</b> p.14
<b>8. MAINTENANCE AND CLEANING:</b> p.15
<b>9. PERIODICAL CHECKS TO YOUR STROLLER:</b> p.16
<b>10. NOTE:</b> p.17
<b>11. WASTE DISPOSAL:</b> p.17
<b>12. LABELLING AND SYMBOLS:</b> p.18
<b>13. WARRANTY DECLARATION:</b> p.19

**13. WARRANTY DECLARATION:**

The warranty covers a period of 24 months from the purchase date for any production fault of the product throughout the European Community. The warranty shall be void in case of any attempt of repair or interventions carried out by someone other than the authorised personnel, any damages caused by accidents, negligence or improper use contrary to what specified in the User's Manual, or failure to maintain the product as provided for in the User's Manual.

The faulty item shall always be accompanied by the purchase receipt or invoice or any other evidence proving the purchase date and a brief description of the fault detected.

During the warranty period your dealer shall apply the warranty terms as laid down in Articles 128-135 of the Consumer Code (Legislative Decree no. 206 of 2005).

## Stroller BETA

### 12. LABELLING AND SYMBOLS:



	This product conforms to the standards of Medical Directive 93/42/EEC as implemented by Legislative Decree 46/97 as amended and supplemented		
	Article Code		Max. user's weight
	Manufacturer		Max. user's weight
	Year of production		Max. safety load
	Applied part type B		Batch
	Leggere il manuale prima dell'uso		Double insulation
	This symbol indicates the presence of hazards which might jeopardise the user's life and cause health problems		This symbol indicates a general useful suggestion. Following this suggestion, it will be easier to use the device and to understand the instructions

## Stroller BETA

### 1. GENERAL INFORMATION:

Dear Customer,

We wish to thank you for purchasing the Stroller BETA and the trust shown in our products.

The Stroller BETA has been devised to provide the user with maximum comfort and safety, and it is suitable for indoor and outdoor use.

The Stroller BETA complies with all the requirements of Directive 93/42/EEC for medical products, as implemented by Legislative Decree 46/97 as amended and supplemented, and it is classified as a **Class I** medical device.

This user's manual contains safety instructions which must be fully respected. All the people involved with using the Postural Stroller ETA must know the complete contents of this manual and observe the safety warnings herein contained.



#### Warning!

**Read through this whole manual in order to avoid causing any damage to the device due to improper use.**

**Movi S.p.A may not be held liable for any damage caused by improper use of the device or by any use other than that stated in this manual.**

### 2. SAFETY WARNINGS:

Before any use, we recommend checking the general state of the device and that it is undamaged through an accurate visual inspection. Should the device be left unused for long periods, carefully check the state of all its components and have them maintained if necessary. Run checks on all the parts that wear out (wheels, brakes, seat and backrest upholstery, footplate, etc.) on a regular basis. Should the stroller be faulty, do not use it and contact your dealer or a specialised assistance centre.



**Warning!**  
**Maximum safe use load is 50 kg.**  
**Never exceed this weight.**

To prevent any damage to property, the stroller or its user, observe the following warnings:

- ◇ Do not use your stroller in sand, rough areas, wet and glade - like surfaces or surfaces with little grip.
- ◇ Engage the brakes when you use the stroller in a lift and when you want to get off.
- ◇ The stroller may be transported in all vehicles, including vehicles which have been especially adapted and/or for the transport of the stroller, and remains, however, at your own risk.
- ◇ During transport, the stroller may not be used as a seat in a vehicle.
- ◇ Never use the stroller when something is broken.
- ◇ Never attach anything to the wheels.
- ◇ Do not push the stroller if you have engaged the brakes. This may cause damage to the device and may put your child in a dangerous situation.
- ◇ Do not let your child stand on the footplate. This may cause the stroller to tilt over resulting in damaging the stroller and/or injuring the child.
- ◇ When folding and unfolding the device, pay additional attention to your hands. Make sure they do not get crushed.
- ◇ The stroller may be used by one person at a time. Do not let anybody sit on the user's lap while using it.
- ◇ A sudden change of direction may cause the stroller to fall over. Avoid this by keeping the same direction when pushing the stroller.

### 10. NOTE:



The manufacturer reserves the right to modify in any moment and without advance notice the components, weight, size and features of its products, if necessary. All data, dimensions and measurements in this manual are approximate and do not represent specifications.

**Movi S.p.A may not be held liable for any damage caused by improper use of the device or by any use other than that stated in this manual.**

### Manufacturer's address

COMPANY: Movi S.p.A  
Address: Via Dione Cassio, 15 - 20138 Milano  
Phone number: +39 02 509051  
E-mail: [infowimed@movigroup.com](mailto:infowimed@movigroup.com)

To order spare parts, for any requests or assistance and for further information please contact the manufacturer or the retailer.

### 11. WASTE DISPOSAL:

We invite you to contribute to safeguarding the environment complying with the national and/or local regulations on waste sorting. For the disposal of materials contact the local authorities responsible for waste disposal, which will receive them free of charge, or alternatively, contact the local reseller. Complying with these regulations contributes to saving valuable resources and avoiding potential negative impact on human health and the environment. In the event of proven contamination of the device, sanitize it before its disposal or dispose of it as special waste.

### 9. PERIODICAL CHECKS TO YOUR STROLLER:

#### Periodical maintenance

Preventive maintenance is fundamental and you can easily do many of these things yourselves.

In the event of any fault, contact the dealer for the necessary repairs.

##### *Every month*

- ◇ Check the folding ability of the stroller.
- ◇ Check the upholstery for wear.
- ◇ Check the front and rear wheel movement as well as their turning ability.
- ◇ Check whether the brakes are working correct.

##### *Every three months*

- ◇ Check all bolts, screws and nuts and tighten them if necessary.
- ◇ Check tyre tread for wear.

- ◇ Movi Spa - Wimed Division does not guarantee the smooth functioning and safety of the device in case of use of non-original components.
- ◇ Never leave your child unattended in the stroller. Make sure you keep your child within sight at all times.
- ◇ Always use the five-point harness. This shall prevent the child from falling and/or sliding out of the stroller thus avoiding any serious injuries.
- ◇ Make sure that the stroller is always standing on its four wheels on the ground.

### 3. PRODUCT DESCRIPTION:

The stroller is equipped with various components and parts. We recommend studying these components and parts before reading this user's manual. The stroller is a super comfortable device, made of high quality materials. It is supplied with a five-point harness belt and an adjustable footplate, as well as a wide range of accessories, which include side cushions and leg warmer.



- A. Rain cover
- B. Five-point harness belt
- C. Footplate
- D. Padded seat
- E. Folding/unfolding lock
- F. Brake

### 8. MAINTENANCE AND CLEANING:

#### Maintenance

The stroller needs regular maintenance, which is required to guarantee long and optimum comfort for the user. A badly maintained stroller will cause more technical problems and will not be covered by the warranty. In the event of any fault, contact the dealer for the necessary repairs.



**Movi Spa - Wimed Division does not guarantee the smooth functioning and safety of the stroller in case of use of non-original components.**

#### Cleaning

Cleaning your stroller is important and should be done regularly. You can best clean your stroller if you follow the directions below.

- ◇ Clean the upholstery, the frame and plastic components regularly with mild soap and water.
- ◇ Never use abrasive cleaners as they can damage the paint. Never use steam or high pressure cleaners either.
- ◇ Wax the paint of the frame on a regular basis.
- ◇ Never use solvents, abrasive waxes, caustic chemicals or silicone spray.
- ◇ Dry the stroller after cleaning and after it has been in a rainstorm, for example.

## Stroller BETA

### 7. ACCESSORIES:



Side cushions



Leg warmer

## Stroller BETA

### 4. TECHNICAL FEATURES:

Seat width:	38 cm
Depth:	27 cm
Backrest height:	52 cm
Total depth:	82 cm
Total weight:	8 kg
Max. safe use load:	50 kg



### 5. DRIVING TECHNIQUES:



It is very important to become familiar with the right and safe user instructions. Therefore, you need to know all the components of the stroller herein described. Always contact an expert if you need any support in finding the right and safe methods that best suit the physical features of the user of the stroller.

#### Balance

Daily operations such as getting on and off the stroller, reaching and bending in stroller will cause change in the weight distribution and the centre of gravity of the user and the stroller. These movements and techniques shall be performed as shown below.

#### How to place the child in the stroller safely

It is important to safely place your child in the stroller. Make sure the user wears the five-point harness at all times. By doing so, he/she will not fall/slide out of the stroller, thus avoiding serious accidents.

#### Going up a gradient

If you want to go up a gradient, face it head-on. By pushing on the push handle the castors will lift at the front. This will form a lever allowing the stroller to be driven up the gradient. It is also important not to add any extra weight like bags to the stroller. In this way, the centre of gravity is located behind the stroller and the risk of tipping is higher.

#### Going down a gradient

If you want to go down a gradient, face it head-on, then push on the push handle. This will form a lever allowing the castors to lift at the front. Carefully drive forwards and place the castors on the lower ground. Then drive slowly, so that the rear wheels are placed on the lower ground. Do not push too fast, because the rear wheels will bounce on the lower ground. This may be dangerous for the child and the stroller.

### Central brake



### How to adjust the footplate height





## Stroller BETA

### How to mount the safety belts



### How to fasten the 5-point belt and the shield chest belt



## Stroller BETA

### 6. ASSEMBLY AND ADJUSTMENTS:

The stroller is made up of various adjustable components. If you wish to add or remove any of its components, make any adjustments or replace the components, you should always follow the instructions described in this user's manual.

### How to fold and unfold the stroller

The stroller is designed to be easily transported by car. To fold or unfold it, follow a few simple steps. When folding and unfolding the stroller, always be careful that the stroller does not get damaged.



### How to unfold the stroller

## Stroller BETA

### How to fold the stroller



### How to place the rain cover



## Stroller BETA

### How to assemble the heel straps

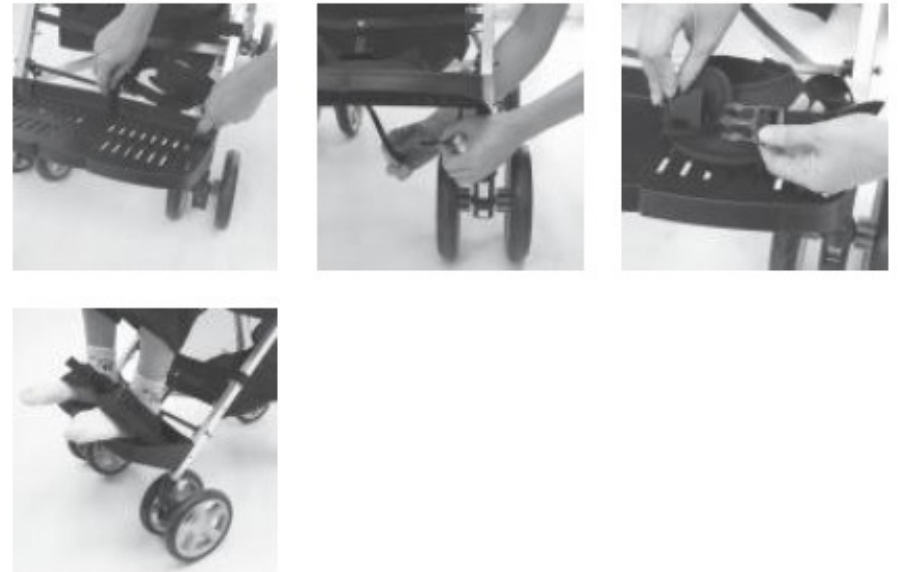

### How to place the leg warmer

